

UNIVERSAL BRUSHCUTTER HEADS



Professional manual 2 line head.
Top quality nylon head. Spool
Studs protrude through the head

G6-224

Our
Part No

9.75



Professional manual 2 line head.
Top quality nylon head.
2.4mm diameter. As G6-224 but
without protruding Spool Studs.

G6-202

9.75



Professional, nylon 2-line "bump &
cut" type head. 2.4mm diameter

G6-526

14.95



2 line manual head. Quality at a
bargain price. Suitable for
machines up to about 30cc.
2.4mm diameter

G6-225

6.50

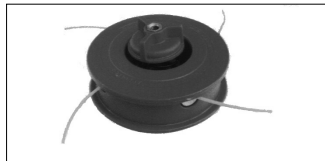

4 line professional manual head.
Like the 2 line head but longer
lasting.
2.4mm diameter

G6-527

14.95

TEL: (0114) 251 3344

FAX: (0114) 251 3000

OR

E-MAIL sales@garfitts.comWWW.GARFITTS.COMWWW.TINES.CO.UK

UNIVERSAL BRUSHCUTTER HEADS



Description	Our Part No	Price £
Professional, universal manual brushcutter head. Fixes without a bolt. 2.4mm diameter	G6-301	14.95



Professional, universal semi automatic "bump & cut" type. Fixes without a bolt. 2.4mm diameter	G6-302	16.95
--	--------	-------



This head has universal application with use of adapter ring. Very flexible plastic blades, less likely to break. (Supplied with 12 Replacement Blades)	G6-600	14.95
---	--------	-------

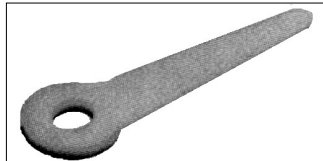

Replacement blades	G6-525	0.25
--------------------	--------	------

BRUSHCUTTER BOLTS & NUTS

Left hand threaded Bolts and Nuts to enable you to fit Brushcutter Blades to your machine.

Please enquire if you are unsure of which one you require.

Description & Size	Pitch Thread	Our Part No	Price £
Nut M8	1.25	G76-002	0.99
Nut M10	1.00	G76-003	0.99
Nut M10	1.25	G76-004	0.99
Nut M10	1.50	G76-005	0.99
Nut M12	1.50	G76-006	0.99
Nut M12	1.75	G76-007	0.99
Bolt M7	1.00	G76-008	0.99
Bolt M8	1.25	G76-009	0.99
Bolt M10	1.25	G76-010	0.99
Bolt M10	1.50	G76-011	0.99

BRUSHCUTTER BLADES

3 Teeth Universal

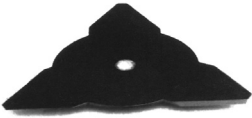

OUTER Ø (mm)	BORE Ø (mm)	THICKNESS (mm)	APPLICATION	PART NO.	PRICE £
265	20	2.5	Grass & Brush cutting	G6-537	6.95
265	25.4	2.5		G6-538	6.95

3 Teeth

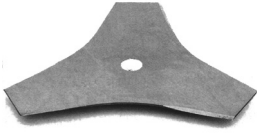

OUTER Ø mm	BORE Ø (mm)	THICKNESS (mm)	APPLICATION	PART NO.	PRICE £
250	25.4	1.6	Grass & Brush cutting	G6-064	3.95
250	20	2		G6-061	4.95
255	25.4	2		G6-060	4.95
280	20	2		G6-049	4.95
280	25.4	2		G6-062	4.95

4 Teeth Steel

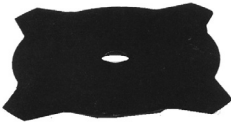

OUTER Ø mm	BORE Ø (mm)	THICKNESS (mm)	APPLICATION	PART NO.	PRICE £
200	20		Grass & Brush cutting	G6-514	3.95
200	25.4			G6-515	3.95
230	20			G6-516	4.95
230	25.4			G6-517	4.95
255	20			G6-518	5.20
255	25.4			G6-519	5.20

4 Teeth - Japan



OUTER Ø mm	BORE Ø (mm)	THICKNESS (mm)	APPLICATION	PART NO.	PRICE £
200	20	2	Grass & Brush cutting	G6-007	3.95
200	25.4			G6-008	3.95
230	20			G6-009	4.95
230	25.4			G6-010	4.95
250	20			G6-011	5.25
250	25.4			G6-012	5.25
250	25.4	2		G6-066	5.25

4 Teeth Steel



OUTER Ø (mm)	BORE Ø (mm)	THICKNESS (mm)	APPLICATION	PART NO.	PRICE £
230	25.4		Grass & Brush cutting	G6-050	4.95
230	20			G6-051	4.95
275	20			G6-052	9.25

4 Teeth Steel

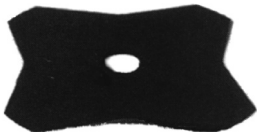

BRUSHCUTTER BLADES

2 Teeth Steel

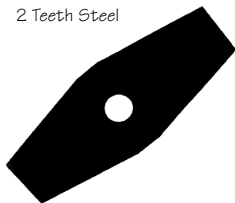

OUTER Ø (mm)	BORE Ø (mm)	THICKNESS mm	APPLICATION	PART NO.	PRICE £
200	25.4		Brush Cutting	G6-520	2.95
230	20			G6-015	2.95
230	25.4			G6-521	2.95
250	20			G6-016	2.95
250	25.4			G6-522	2.95
350	20			G6-091	2.95
350	25.4			G6-092	2.95

2 Teeth Steel



OUTER Ø (mm)	BORE Ø (mm)	THICKNESS mm	APPLICATION	PART NO.	PRICE £
250	20	3	Brush Cutting	G6-078	2.95
250	25.4	3		G6-079	2.95
300	20	3		G6-081	3.25
300	25.4	3		G6-082	3.25
250	25.4	2		G6-065	3.95
280	25.4	2		G6-063	2.95

3 Teeth Steel

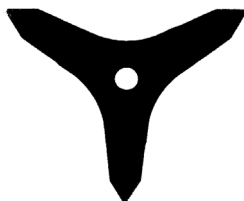

OUTER Ø (mm)	BORE Ø (mm)	THICKNESS mm	APPLICATION	PART NO.	PRICE £
255	20	3	Thicket Brambles Undergrowth Shrubs & Bushes Brushwood	G6-003	5.70
255	25.4	3		G6-001	5.70
300	20	3		G6-501	8.90
300	25.4	3		G6-013	8.90
300	20	4		G6-042	9.50
300	25.4	4		G6-048	9.50
350	20	4		G6-002	14.25
350	25.4	4		G6-004	14.25

3 Teeth - Japan



OUTER Ø (mm)	BORE Ø (mm)	THICKNESS (mm)	APPLICATION	PART NO.	PRICE £
230	20			G6-017	4.50
230	25.4			G6-005	4.50
255	20			G6-018	4.95
255	25.4			G6-006	4.95

3 Teeth - Electrolux



OUTER Ø (mm)	BORE Ø (mm)	THICKNESS (mm)	APPLICATION	PART NO.	PRICE £
250	20	2.2	Grass & Brush cutting	G6-019	5.95
300	20	2.5		G6-027	9.95

Continues Next Page >>>>>

TEL: (0114) 251 3344 FAX: (0114) 251 3000

BRUSHCUTTER BLADES

4 Teeth Steel



OUTER Ø mm	BORE Ø (mm)	THICKNESS mm	APPLICATION	PART NO.	PRICE £
230	20		Grass & Brush cutting	G6-074	3.95
230	25.4			G6-071	3.95
255	20			G6-072	4.40
255	25.4			G6-073	4.40

8Teeth Steel



OUTER Ø mm	BORE Ø (mm)	THICKNESS mm	APPLICATION	PART NO.	PRICE £
200	20		Grass & Brush cutting	G6-502	4.50
250	25.4	2		G6-067	4.95
200	25.4			G6-505	4.50
230	20			G6-503	5.40
230	25.4			G6-506	5.40
250	20			G6-504	5.95
250	25.4			G6-507	5.95

Steel Saw Blade
80 Teeth

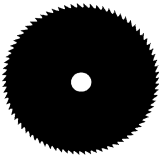

OUTER Ø mm	BORE Ø (mm)	THICKNESS mm	APPLICATION	PART NO.	PRICE £
200	20	1.4	Thicket Brambles Undergrowth Shrubs & Bushes Brushwood Grass & Brush cutting	G6-511	6.25
200	25.4	1.4		G6-508	6.25
230	20	1.6		G6-512	6.49
230	25.4	1.6		G6-509	6.49
250	20	1.6		G6-513	7.20
250	25.4	1.6		G6-510	7.20

Plastic Blades

		OUTER Ø (mm)	BORE Ø (mm)	APPLICATION	PART NO.	PRICE £
A	3 TEETH	250	25.4	Grass, brushwood etc. Grass, weeds For grass cutting. Once outer blades have worn down they can be cut off to leave a smaller diameter cutting blade	G6-528	2.50
B	4 TEETH	230	25.4		G6-529	2.75
C	8 TEETH	220	20		G6-530	3.75
		220	25.4		G6-531	3.75
		255	25.4		G6-532	4.25

Plastic Blades

