

SWITCHES UNIVERSAL

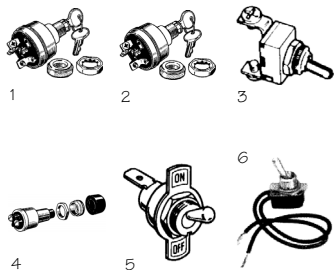

Key No	Description	Our Part No	Price Each
1	Starter Switch, 4 positions, 5 terminal	G430-041	16.25
2	Starter Switch, 3 positions, 4 terminal	G430-033	15.65
3	Toggle Switch, 2 terminals - "On/Off"	G430-066	2.95
4	Starter Switch, Push Button, 2 terminal	G430-165	4.95
5	Kill Switch, single wire, self ground - "On/Off" indicator.	G430-017	2.25
6	Toggle Switch, 2 wire, "On/Off" indicator	G430-074	2.60

ELECTRICAL TAPE & CABLE TIES

Description	Width (mm)	Length mm	Our Part No	Price Each
Cable Tie, black	2.5	102 (4")	G1-011	5.60
Cable Tie, black	4.8	151 (6")	G1-012	7.30
Cable Tie, black	4.7	204 (8")	G1-013	11.50
Insulation Tape, black	19.0	33 metre	G1-014	2.50

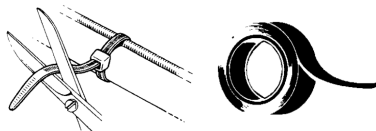

CABLE TIES SUPPLIED IN PACKS OF 100

ELECTRICAL CABLE & ADAPTERS

TWIN SOCKET CABLE REELS				
Key No	Part No.	Cable Length	Max Load	Price Each
1	GW72718	10m	10A	13.10
1	GW72719	15m	10A	17.98
2	GW72720	25m	13A	22.50

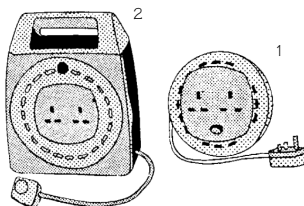

RCD ADAPTER



230-240 volts AC
13A. Provides Visual
Indication of a socket
wiring fault.

£28.88
GW38567

Electrical Terminal Set
150 pieces
Part No GL2214
Price £13.95

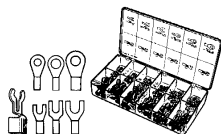

ELECTRICAL TERMINALS

Electrical Crimping / Cable Stripping Pliers
Heavy duty with insulated handles, Gauged. Part
No GW465 Price £4.95

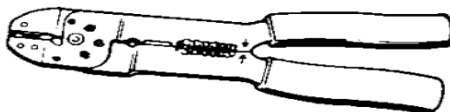

REFER TO OEM SECTION FOR SPECIFIC ITEMS