

## 422, 518 & 522 PARTS

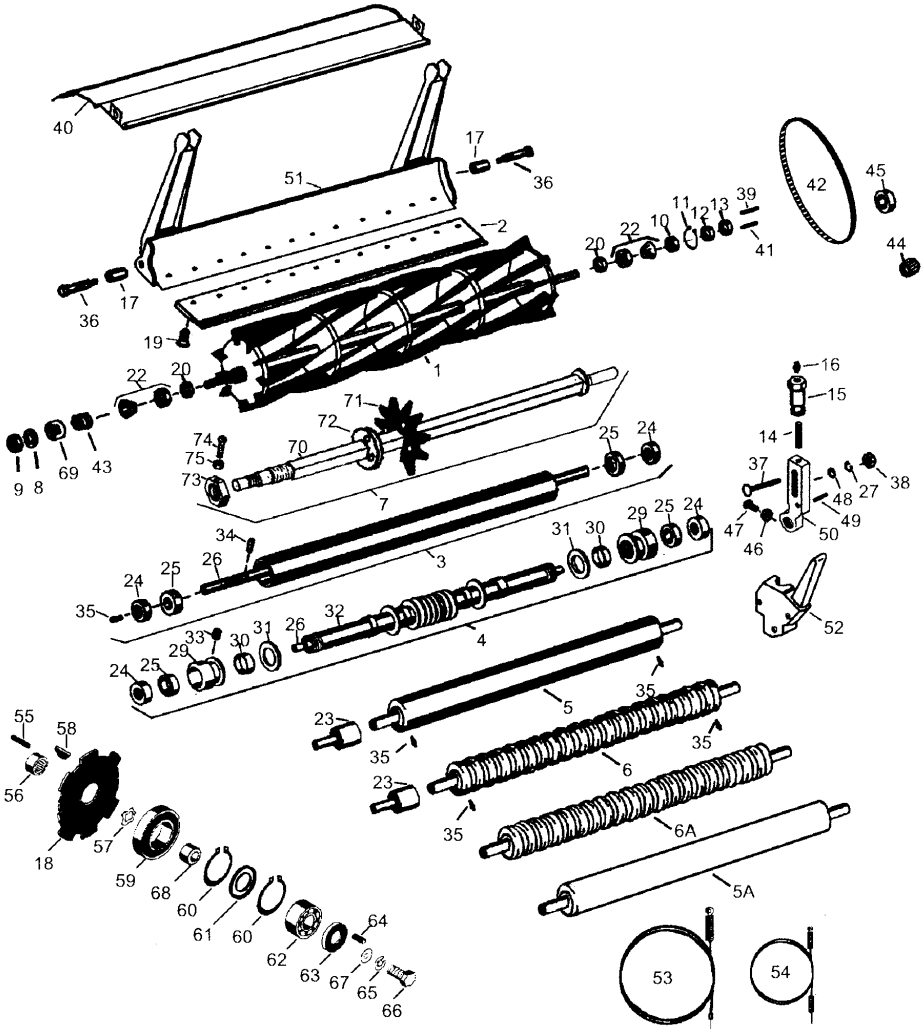

**422, 518 & 522 PARTS**

Key No	O.E.M Part No	Description	Our PartNo	Price £
Reels Available, Lifetime Guaranteed				
1	5000095	18" Reel, 11 Blade, fits 518	G5000095	169.95
1	5000148	22" Reel, 11 Blade, fits 422 & 522	G5000148	149.95
1	503616	Use G5000148	G503616	
Bedknives Available, Lifetime Guaranteed				
2	5000098	18" Bed Knife, Low Cut, fits 518	G5000098	22.65
2	5002888	18" Bed Knife, Tournament, fits 518	G5002888	28.95
2	5001056	Use G5002888	G5001056	
2	5000927	22" Bedknife Tournament 1/16", fits 422 & 522"	G101258	25.95
2	503479	22" Bedknife Super Thin 3/32", fits 422 & 522	G101259	21.95
2	503479	22" Bedknife Super Thin 3/32", fits 422 & 522 Tungsten Tip	G101259TP	55.85
2	101260	22" Bedknife Thin 1/8", fits 422 & 522	G101260	20.95
2	101260	22" Bedknife Std 1/8", fits 422 & 522 Tungsten Tip	G101260TP	53.30
2	101261	22" Bedknife Thick 3/16", fits 422 & 522	G101261	19.95
Rollers Available				
3	158776	Solid Roller, fits 422 & 522 2" Dia 6 lbs weight 79.22	G158776	84.50
4	68527	Repairable Grooved Roller, fits 422 & 522 2" Dia 91 lbs weight	G68527R	111.25
5	Only	Solid Front Roller, fits 422 & 522 2" Dia 191 lbs weight	G101126	103.95
5A	Only	Front UHMW Plastic Solid Roller, fits 422 & 522 2" Dia 7 lbs weight	G101336	85.25
6	68577	Steel Machined Grooved Roller, fits 422 & 522 2" Dia 14 lbs weight	G68577	118.95
6	Only	Aluminum Machined Grooved Roller, fits 422 & 522 2" Dia 5 lbs weight	G101123	109.95
6	Only	Aluminum Machined Grooved Roller, Fits 518 2-3/16" Dia 41 lbs weight	G101129	149.95
6	Only	Steel Machined Grooved Roller, Fits 518 2-3/16" Dia 121 lbs weight	G101130	149.95
6A	Only	UHMW Plastic Grooved Roller, fits 422 & 522 2" Dia 7 lbs weight	G101330	91.95
Minuteman Rollers Available				
0	MJ2201	Minuteman 22" Front Grooved Roller Assy., with brackets	GMJ2201	189.00
0	MJ2401	Minuteman 18" Front Grooved Roller Assy., with brackets	GMJ2401	185.00
0	M511	Minuteman 22" Grooved Front Roller Only	GM511	145.00
0	M5050	Minuteman 18" Grooved Front Roller Only	GM5050	135.00
0	J221	Minuteman Front LH & RH Roller Bracket	GJ221	30.00
0	MMB157	Minuteman Bearing & Locking Collar	GMMB157A	11.95
Overhaul Kits Available				
7	Only	Vertical Mower Conversion Kit, Fits 422 & 522 Incl: 1 ea. G101163 Shaft, G352437 Nut, 26 G101160 Vertical Mower Blades & 76 G35221 Nylon Spacers	G101164	259.95
Other Parts Available				
8	366648	Outer Seal, Reel Adj. End	G364170	2.55
9	445748	Hex Nut, Reel	G3296-15	1.25
10	366649	Outer Seal, Reel Drive End	G366649	1.59
11	458461	Snap Ring, Reel	G458461	0.55
12	366652	Inner Bearing, Belt Drive	G366652	6.25
13	365229	Outer Bearing, Belt Drive	G365229	8.75
14	343616	Stud, Roller Adjusting	G343616	3.69
15	365009	Adjusting Knob, Roller	G365009	9.80
16	471219	Grease Zerk, Adjusting Knob	G471219	1.30
17	545940	Bushing, Bed Bar	G545940	3.95
18	555795	Clutch Disc (Set of 2)	G555795	20.45
19	402578	Screw, Bed Knife	G101272	0.20

Continues Next Page >>>>>

Parts are not original. OEM part numbers are for reference purposes only.

## 422, 518 &amp; 522 PARTS

Key No	O.E.M Part No	Description	Our PartNo	Price £
20	366650	Inner Seal, Reel	G366650	3.95
22	500534	Bearing & Cup, Reel	G500534	6.05
22	Only	Bearing, Reel	G254-78	3.95
22	Only	Cup, Reel	G254-79	2.10
23		Bearing, Machined Grooved Roller	G101481	15.25
24	305115	Seal Roller	G305115	2.59
25	303558	Bearing, Roller	G303558	7.60
26	102030	Front Roller Shaft	G102030	21.95
27	446136	Lockwasher, 5/16	G446136	0.08
29	Only	2" Threaded Roller End	G150650	26.45
30	Only	Spacer, Repairable Grooved Roller	G150651	0.42
31	Only	Washer, Repairable Grooved Roller	G150652	0.38
32	Only	Threaded Tube	G150654	16.45
33	Only	Nyloc Set Screw, 1/4"-20 x 1/4"	G150690	0.40
34	461359	Roli Pin, 1/8" x 3/4" 0.13	G012419	
35	471214	Grease Zerk, 1/4-28	G302-5	0.49
36	365501	Bolt, Bed Bar/Pivot	G365501	7.45
37	441674	Carriage Screw, 5/16 x 1 3/4	G441674	0.42
38	443106	Nut, 5/16-18	G443106	0.10
39	320774	Key, 3/16 x 3/16x 1 1/4	G320774	0.75
40	340474	Grass Shield	G340474	19.95
41	345556	Key, 1/8 x 1/8x 1	G345556	0.28
42	366881	Use G5001122	G366881	
42	366882	Use G5001123	G366882	
42	366666	Use G5001124	G366666	
42	5001122	Belt, 80 Tooth (.460" wide)	G5001122	20.45
42	5001123	Belt, 90 Tooth (.460" wide)	G5001123	23.45
42	5001124	Belt, 112 Tooth (.460" wide)	G5001124	26.45
42	5002403	Belt, 80 Tooth, 17mm wide (.669")	G5002403	24.55
42	5002915	Belt, 90 Tooth, 17mm wide (.669")	G5002915	24.95
43	363047	Spring, Reel	G363047	2.20
44	367553	Needle Bearing	G367553	6.80
44	367554	Needle Bearing	G367554	6.79
45	366707	Ball Bearing	G4203603	7.45
46	443102	Nut, 1/4-20	G443102	0.09
47	352737	Set Screw, Square Head	G352737	0.34
48	364441	Fiatwasher, 5/16	G310266	0.10
49	461339	Grooved Pin, Roller Bracket	G461339	0.45
50	2000072	Roller Bracket, Long, use with 7 Blade Reel	G2000072	8.65
50	2000040	Roller Bracket, Short, use with 11 Blade Reel	G2000040	8.45
51	5000102	Bed Bar, 18H, Fits 518	G5000102	144.95
51	5000457	Bed Bar, 22h, Fits 522	G5000457	149.95
52	241827	Bracket, LH, Grass Catcher (Shown)	G241827	36.95
52	241828	Bracket, RH, Grass Catcher	G241828	36.95
53	366741	Brake Cable	G366741	15.95
54	3002477	Clutch Cable, Fits 518-522	G3002477	19.95
55	320774	Key, Clutch 3/16 x 1-1/2"	G320774	0.75
56	340807	Needle Bearing, Clutch	G340807	10.75
57	366689	Wave Washer, Clutch	G366689	1.95
58	463113	Key, Clutch Shaft	G463113	0.40
59	367365	Bearing, Clutch, 518-522	G367365	8.95
59	366688	Bearing, Clutch, 422	G366688	34.95

Continues Next Page &gt;&gt;&gt;&gt;&gt;

**422, 518 & 522 PARTS**

Key No	O.E.M Part No	Description	Our PartNo	Price £
60	458113	Snap Ring,Clutch	G458113	0.95
61	366685	Grease Seal, Clutch	G366685	4.75
62	366684	Bearing, Clutch	G366684	39.95
63	366648	Seal, Clutch	G364170	2.70
64	367082	Key, Clutch Pulley, 3/16" x 3/4"	G367082	0.65
65	446142	Lockwasher, 3/8"	G3254-6	0.08
66	400262	Bolt, Clutch, Hex Head 3/8-16 x 1"	GF3205	0.40
67	366653	Spacer	G366653	1.85
68	366686	Wear Sleeve	G366686	4.95
69	364900	Nut, Reel Adjusting	G364900	4.75
70	Only	Shaft, Vertical Mower	G101163	119.95
71	Only	Blade, Vertical Mower	G101160	3.70
72	352221	Spacer, Nylon	G352221	0.68
73	352437	Nut, Incl #103& 104	G352437	5.95
74	412017	Screw, Sq. Hd. Set	G412017	0.60
75	443106	Nut, Jam	G443106	0.10



400 ml. aerosol  
Part No. WD40-400



5 litres with applicator  
Part No. WD4-5L

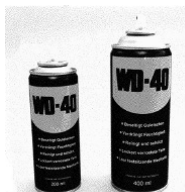
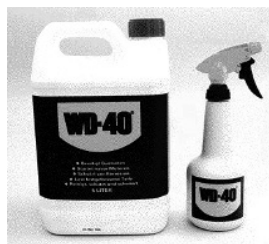

**THE PROBLEM SOLVER**

HOW  WORKS

WD-40's success is based on one simple property. It has a very high surface attraction to metal. It is wetter than water. It completely wets all metal surfaces even in the presence of moisture, coating even microscopic irregularities. In this way it can spread its active ingredient under moisture, through rust and corrosion and into the hardest to reach areas. These ingredients form a protective, moisture-proof and electrically non conductive barrier on the metal.