

FAIRWAY & BLITZER
TYRE & WHEELS

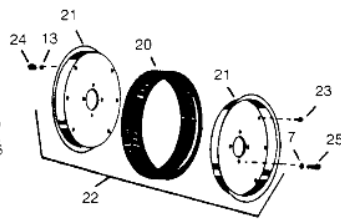

Key No	OEM Part No	Description	Our Part No	Price £
STEEL WHEELS				
1	203987	18" Wheel, Rim 18" OD	G203987	63.95
1	203992	17" Wheel, Rim 17" OD	G203992	72.95
2	315938	18" Disc. 17" OD use with G203987	G315938	34.95
2	315939	17" Disc. 15 1/2" OD use with G203992	G315939	31.95
3	400226	Bolt, 5/16-24 x 1"	G400226	0.25
4	310266	Flat Washer	G310266	0.08
5	444754	Locknut, 5/16"	G444754	0.20
6	400436	Bolt, 1/2-20 x 7/8	G400436	0.33
7	446152	Lockwasher, 1/2"	G446152	0.10

PNEUMATIC WHEELS				
9	318144	Tube, 4.80 x 9	G318144	12.75
10	317872	Wheel Half with Valve Hole 4.80 x 9	G317872	9.95
11	317873	Wheel Half without Valve Hole 4.80 x 9	G317873	9.95
12	400294	Bolt, 3/8-24 x 3/4"	G400294	0.65
13	446140	Lockwasher, 3/8"	G446140	0.08
14	443112	Nut, 3/8-24 x 3/4"	G443112	0.20
15	400442	Bolt, 1/2-20 x 1 1/2"	G400442	0.95
7	446152	Lockwasher, 1/2"	G446152	0.10
16	317871	Spacer	G317871	3.48
18	108093	Wheel, 4.00 x 12	G108093	59.95
19	358489	Tyre, Goodyear 4.80 x 12	G358489	42.95
19A	-	Tube, 4.80 x 12	G700132	13.55

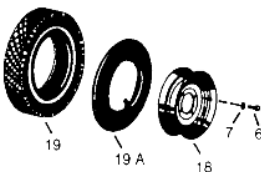
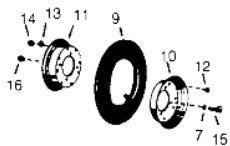
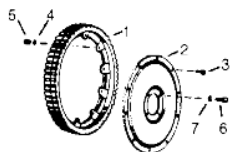

SEMI-PNEUMATIC WHEELS				
20	316482	4 x 20 Tyre, 20" OD	G316482	38.95
20	344137	4 x 17 Tyre, 17" OD	G344137	38.95
21	329120	17 Disc Half, 14" OD with G344137	G329120	29.45
21	336054	20 Disc Half, 17" OD with G316482	G336054	29.75
22	70094	4 x 17 Wheel Assembly, set of 2	G70094	180.95
22	70097	4 x 20 Wheel Assembly, set of 2	G70097	180.95
23	400258	Bolt, 3/8-16 x 3/4"	G400258	0.26
13	446140	Lockwasher, 3/8"	G446140	0.08
24	443110	Nut, 3/8 - 16	G443110	0.09
25	400438	Bolt, 1/2-20 x 1"	G400438	0.45
7	446152	Lockwasher, 1/2"	G446152	0.10

Parts are not original. OEM part numbers are for reference purposes only.

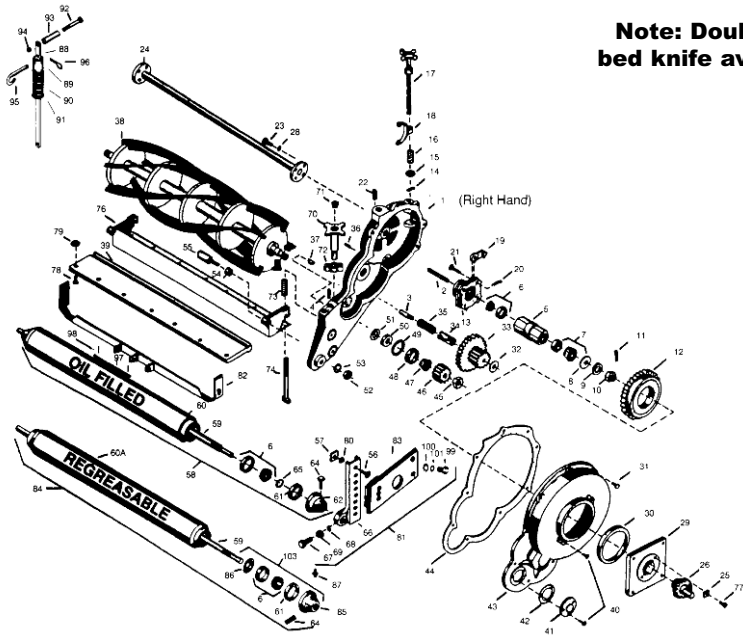
BLITZER
MOWING UNIT



Note: Double lip bed knife available

KeyNo	OEM Part No	Description	Our Part No	Price £
		Overhaul Kit Overhaul Kit, inc. Gaskets Seals, etc. to repair one Roller	G500605	62.65
		Regreasable Conversion Kit Oil Filled Regreasable Conversion Kit to rebuild one Roller	G700505	65.95
		Oil Filled Roller Overhaul Kit Oil Filled Roller Overhaul Kit to rebuild one Roller	G100140	59.45

Parts are not original. OEM part numbers are for reference purposes only.

**BLITZER
MOWING UNIT**

Key No	OEM Part No	Description	Our Part No	Price £
1	109550	Gear Housing LH, including nos. 2-4 & 48	G109550	153.95
1	109551	Gear Housing RH, including nos. 2-4 & 48	G109551	153.95
2	545515	Stud, Ground Wheel	G545515	8.35
3	315851	Internal Stud	G315851	6.55
4	461406	Roll Pin	G461406	0.55
5	500236	Cylinder, Wheel with 1 x G500533 & G500534	G500236	42.95
6	500534	Bearing & Cup, Roller	G500534	7.95
7	500533	Bearing, Cup & Ring	G500533	7.35
8	311957	Nilos Ring	G311957	1.55
9	453022	Washer, 3/4 SAE	G453022	0.20
10	445686	Axle Nut, 3/4-16 Castle	G445686	1.60
11	460028	Cotter Pin 1/8 x 1	G460028	0.13
12	203976	Main Gear, Ductile Iron	G203976	66.75
13	203975	Wheel, Pawl Carrier	G203975	55.95
14	460026	Cotter Pin, 1/8 x 3/4	G460026	0.10
15	315861	Washer	G315861	0.40
16	316765	Spring, RH	G316765	1.95
16	316766	Spring, LH	G316766	1.95
17	153215	Release Handle	G153215	14.85
18	203968	Fork, Release	G203968	15.95
19	204871	Pawl, Main Gear, Ductile Iron	G204871	3.18
20	460012	Cotter Pin, 3/32 x 3/4	G460012	0.10
21	315867	Hardened Pin, Pawl	G315867	0.29
22	472205	3/8" Plug	G472205	0.68
23	400406	Bolt, Hex Head 1/2-13 x 1 1/4	G400406	0.68
24	108126	Axle, Main Blitzer	G108126	71.95
25	327676	Tab, Locking	G327676	0.51
26	204119	Cap, Hub	G204119	12.92
28	446152	Lockwasher, 1/2"	G446152	0.10
29	203984	Hub, Ground Wheel	G203984	59.95
30	315967	Seal, Cover	G315967	4.83
31	407706	Screw, Housing Cover	G407706	0.18
32	302295	Washer	G302295	0.24
33	331834	Internal Gear, Ductile Iron	G331834	49.82
34	315978	Sleeve, Roller Bearing	G315978	0.90
35	315977	Roller Bearing, Internal Gear	G315977	3.05
36	472203	1/4" Plug	G472203	0.58
37	315877	Key, Pinion	G315877	0.88
38	-	Cylinder, G Blade - 10"Ø, Blitzer	G101253	128.00
38	502673	Cylinder, 5 Blade - 10"Ø, Blitzer	G502673	125.85
38	502674	Cylinder, 4 Blade - 10"Ø, Blitzer	G502674	117.85
39	325163	SL Bed Knife - 1/2" H.O.C.	G101250	21.55
39	325163	SL Bed Knife, Low Cut - 7/16" H.O.C.	G101250L	23.95
39	315834	DL Bed Knife 1/2" H.O.C.	G101251	28.95
40	408052	Screw, 12-24 x 1/2 Binding Head	G408052	0.25
41	352635	Cap, Cover	G352635	1.45
42	315876	Gasket, Inspection Plate	G315876	0.27
43	203986	Cover Housing	G203986	33.95
44	315928	Cover Gasket	G315928	1.96
45	444742	Nut, Gripco Centre Lock 3/4-16	G444742	0.78
46	315843	Pinion Gear	G315843	13.35
47 & 48	500711	Bearing & Cup, Cylinder	G500711	10.75
47	315914	Cone, Cylinder	G315914	6.67
48	302755	Cup, Cylinder	G302755	3.41
49	315910	Spacer	G315910	0.50
50	315872	Seal, Cylinder	G315872	2.05

Continues Next Page >>>>>

BLITZER
MOWING UNIT

Key No	OEM Part No	Description	Our Part No	Price £
51	315873	Washer, Seal	G315873	0.23
52	443828	Nut, 5/8-18 Hex	G443828	0.36
53	447224	Internal Star Lockwasher, 5/8"	G447224	0.21
54 & 55	500264	Stud & Bushing, Bed Knife Backing	G500264	11.55
54	545723	Bushing, Backing Stud	G545723	3.10
55	315909	Stud, Bed Knife Backing	G315909	8.25
56	400266	Bolt, Hex Head 3/8-16 x 1 1/2	G400266	0.34
57	444510	Nut, 3/8-16 Sq.	G444510	0.21
58	113897	Roller Complete	G113897	113.95
59	328058	Shaft, Roller	G328058	22.95
60	113898	Tube, Roller with Races	G113898	60.50
60A	-	Tube Assembly with Races & Grease Retainer fits G700500	G700503	62.95
61	328062	Seal, Roller	G328062	2.26
62	500574	Roller Collar, Hardened	G500574	22.75
64	412063	Screw, Sq. Head set	G412063	0.59
65	459007	O-Ring, Roller	G459007	0.40
66	500763	Bracket, Roller LH, including 67, 68 & 69	G500763	22.80
66	500764	Bracket, Roller RH, including 67, 68 & 69	G500764	22.80
67	412003	Screw, 1/2-13 x 1 1/2 Sq. Head	G412003	0.60
68	446152	Lockwasher, 1/2 Heavy	G446152	0.10
69	443818	Nut, 1/2-13 Hex Jam	G443818	0.21
70	500548	Adjusting Handle	G500548	15.59
71	312794	Flua, Adjusting Handle	G312794	0.12
72	315964	Spring Friction	G315964	1.15
73	315966	Adjusting Spring	G315966	1.85
73	315844	Adjusting Spring (Special Worn Cylinder)	G315844	2.95
74	316351	Adjusting Screw, Blitzer	G316351	4.00
76	130304	Backing, Bed Bar	G130304	125.00
77	400106	Bolt, Hex Head 1/4-20 x 5/8	G400106	0.15
78	402698	Screw, Bed Knife	G101270	0.26
79	445684	Nut, Bed Knife	G101271	0.26
80	446142	Lockwasher, 3/8"	G446142	0.12
81	-	Skid to Roller Conversion Kit, inc. 56 57 66-69 80 83 100-101	G700480	83.25
82	500238	Skid with Pin, Blitzer	G500238	79.95
83	154217	Support Bracket, LH	G154217	21.75
83	154218	Support Bracket, RH	G154218	21.75
84	-	Rearreasable Roller Assembly, Complete	G700500	124.75
85	-	Rearreasable Roller End, Hardened	G700501	25.46
86	-	Grease Retainer	G700502	0.95
87	-	Grease Fitting 1/4-28	G302-5	0.52
88	110030	Lever Assembly, fits Blitzer	G110030	52.95
88	335677	Lever Only, fits Blitzer	G335677	17.65
89	358414	Adjuster Nut, Lever Assembly	G358414	17.95
90	316133	Spring, Lever Assembly	G316133	11.85
91	110031	Outer Tube, Lever Assembly	G110031	16.95
92	400456	Bolt, Hex Head	G400456	1.10
93	319873	Handle, Tube Only	G319873	2.10
94	443120	Nut	G32146-11	0.40
95	318001	Pin, Lock	G318001	2.50
96	460132	Hairpin, Cotter	G460132	0.40
97	316478	Rod, Fits Blitzer Skid	G316478	3.50
98	460028	Pin Cotter	G460028	0.13
99	400336	Bolt, 7/16"-14 x 1 1/4	G400336	0.35
100	453013	Washer, 7/16"	G453013	0.12
101	446146	Lockwasher, 7/16"	G446146	0.10