

HF - 5

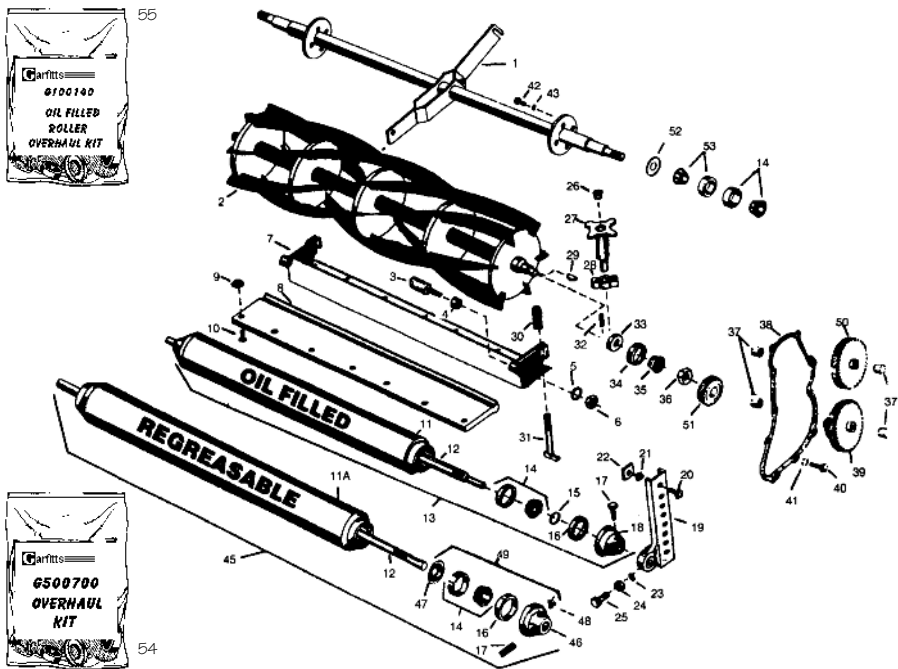

Key No	OEM Part No	Description	Our Part No	Price £
1	122038	Main axle assembly	G122038	139.95
2	502671	Reel, 6 blade 8"Ø	G502671	135.15
2	-	Reel, 8 blade 8"Ø	G502672	145.55
2	502675	Reel, 10 blade 8"Ø	G502675	151.75
3 & 4	500264	Stud & bushing, B.K. backing	G500264	11.54
3	315909	Stud, B.K. backing	G315909	8.25
4	545723	Bushing, backing stud	G545723	3.10
5	447224	Lockwasher, 5/8"	G447224	0.21
6	443828	Nut 5/8"-18 Hex	G443828	0.36
7	130304	Backing, bed knife	G130304	125.00
8	325163	S.L. Bed knife	G101250	21.55
8	325163	S.L. Bed knife low cut	G101250L	23.95
8	315834	D.L. Bed knife	G101251	28.95
9	445684	Nut, bed knife	G101271	0.26
10	402698	Screw, bed knife	G101270	0.26
11	113898	Tube, roller with races	G113898	60.50
11A	-	Regreasable tube assembly, fits G700500	G700503	62.95
12	328058	Shaft, roller	G328058	22.95
13	113897	Roller, complete	G113897	118.50
14	500534	Bearing & cup, roller, bearing	G500534	7.95
15	459007	O-ring, roller	G459007	0.40
16	328062	Seal, roller	G328062	2.26

Continues Next Page >>>>

HF - 15

Key No	OEM Part No	Description	Our Part No	Price £
17	412063	Screw, Square head, set	G412063	0.59
18	500574	Roller collar, hardened	G500574	22.75
19	500763	Bracket, roller LH	G500763	22.50
19	500764	Bracket, roller RH	G500764	22.50
20	400266	Bolt, Hex Head 3/8-16 x 1 1/4"	G400266	0.34
21	446142	Lockwasher, 3/8" 446142	G446142	0.12
22	444510	Nut, 3/8-16 square	G444510	0.21
23	446154	Lockwasher, fl" heavy	G446154	0.13
24	443818	Nut, fi-13 hex jam	G443818	0.21
25	412003	Screw, fi-13 x 1 fi square head	G412003	0.60
26	312794	Plug, adjusting handle	G312794	0.12
27	500548	Adjusting handle	G500548	15.59
28	315964	Spring, friction	G315964	1.15
29	315877	Key, pinion	G315877	0.88
30	315966	Adjusting spring	G315966	1.85
31	315965	Adjusting screw	G315965	3.98
32	461406	Roll pin	G461406	0.55
33	336781	Seal, reel	G336781	1.95
34 & 35	500711	Bearing & cup, reel, bearing	G500711	10.75
34	302755	Cup, reel, bearing	G302755	3.41
35	315914	Cone, reel, bearing	G315914	6.67
36	444742	Nut, gripco centre lock fi-16	G444742	0.78
37	359875	Needle bearing	G359875	2.45
38	390204	Gasket, gear housing	G390204	1.70
39	131170/162219	Internal gear and shaft assembly	G131170	84.95
40	400190	Cover bolt, hex head	G400190	0.20
41	446136	Lockwasher, 5/16"	G446136	0.13
42	400406	Bolt, hex head fi-13 x 1	G400406	0.68
43	446154	Lockwasher, fl"	G446154	0.10
45	-	Regreasable roller assembly	G700500	119.95
46	-	Roller end, regreasable	G700501	25.46
47	-	Grease retainer	G700502	0.95
48	-	Grease nipple	G302-5	0.52
49	-	Roller conversion kit (to convert oil filled to regreasable)	G700505	65.95
50	162220	Idler gear with shaft	G162220	43.95
51	336825	Pinion gear, reel	G336825	21.65
52	359828	Nilos Ring	G359828	1.95
53	502522	Cup & cone, bearing	G502522	9.25
54	-	Overhaul kit	G500700	71.45
55	-	Oil filled roller overhaul kit	G100140	59.45



G100140 Oil filled roller overhaul kit

2	G500574	Roller collar, hardened
2	G500534	Cup & Cone Ass'y, Timken
2	G4590070	Ring, Roller
2	G328062	Seal, roller
2	G412063	Screw, Sq. Hd. Set.

G500700 Overhaul Kit

4	G359875	Bearing, Needle
8	G400190	Cover bolt, hex head
8	G446136	Lockwasher, 5/16"
1	G390204	Gasket, Gear Housing
2	G500711	Cup and Cone Bearing Ass'y
2	G359828	Nilos Ring
2	G502522	Cup & Cone, Timken
4	G500534	Cup & Cone Ass'y, timken
2	G328062	Seal, Roller
2	G4590070	Ring, Roller
2	G315872	Seal, Cylinder

