

## HF - 5111

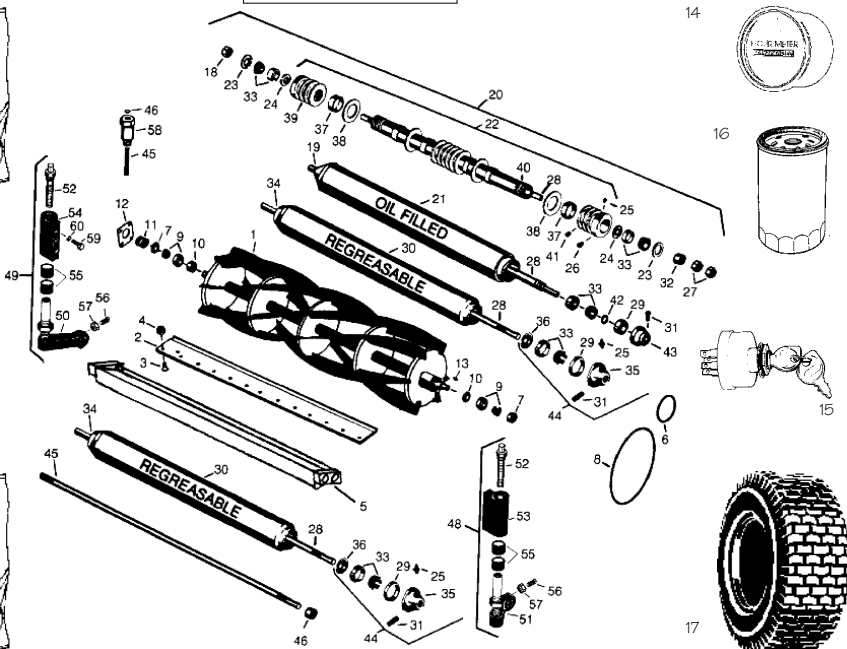

47



48

Key No	OEM Part No	Description	Our Part No	Price £
1	503522	Cylinder, 5 blade RH	G503522	127.50
1	503523	Cylinder, 5 blade LH	G503523	127.50
1	503524	Cylinder, 10 blade RH	G503524	145.35
1	503525	Cylinder, 10 blade LH	G503525	145.35
2	503550	Bed knife, 71/16" H.O.C. Standard	G101256L	25.95
3	403757	Screw, bed knife	G101270	0.26
4	445684	Nut, bed knife	G101271	0.26
5	557618	Backing bar, bed knife	G557618	111.95
6	363034	O-ring seal, reel motor	G363034	0.72
7	337593	Oil seal, reel	G337593	3.67
8	365570	O-ring seal, gear case	G365570	2.90
9	500596	Bearing & cup, reel	G500596	6.75
10	364275	Disc, reel shaft	G364275	1.05
11	350671	Spring, reel	G350671	3.55
12	345473	Gasket, reel motor	G345473	0.32
13	463017	Key, reel	G463017	0.28
14	162723	Hour meter	G12-9990	35.95
15	131095	Key switch G lead	G27-2360	12.95
-	549633	Air Filter	G549633	15.25

Continues Next Page >>>>>

Parts are not original. OEM part numbers are for reference purposes only.

**HF - 5111**

Key No	OEM Part No	Description	Our Part No	Price £
16	555773	Oil filter	G555773	6.95
17	366292	Front tyre, 26-12.00 x 12 6 ply Turf Trac.	G366292	109.95
17	366310	Rear tyre, 23-10.50 x 12 4 ply Turf Trac.	G700181	69.75
18	3296-15	Locknut, fl-16	G3296-15	1.31
19	113897	Roller assembly	G113897	118.50
20	-	Repairable grooved roller assembly	G113897RG	159.95
21	113898	Tube, roller with races	G113898	60.50
22	-	Tube assembly, repairable grooved roller	G113899R	113.95
23	-	Outer seal, roller assembly	G253-117	3.34
24	-	Inner seal, roller assembly	G253-122	2.38
25	-	Grease nipple	G302-5	0.52
26	-	Relief fitting, pressure	G170714	4.19
27	-	Jam nut, fl-16	G3220-7	0.99
28	328058	Shaft roller, 33" long	G328058	22.95
29	328062	Seal, roller	G328062	2.26
30	-	Tube assembly, fits G700500 regreasable roller	G700503	62.95
31	412063	Screw, square head set	G412063	0.59
32	-	Wear sleeve, roller assembly	G150674	6.65
33	500534	Bearing & cup, roller	G500534	7.05
34	-	Regreasable roller assembly, Complete	G700500	119.95
35	-	Regreasable end, hardened	G700501	25.46
36	-	Grease retainer	G700502	0.95
37	-	13/16" Spacer, repairable grooved roller	G150671	0.60
37	-	1 " H.D. Spacer, repairable grooved roller	G150676	1.40
38	-	3" Washer, repairable grooved roller	G150673	0.60
39	-	3" Threaded roller end, fits G113897RG	G150675	42.95
40	-	3" Threaded tube, fits G113897RBG	G150682	26.95
41	-	Nyloc set screw, 3/8"-16 x 3/8"	G150691	0.55
42	-	O-ring, roller	G459007	0.40
43	-	Roller end	G500574	22.75
44	-	Roller conversion kit	G700505	65.95
45	364625	Adjusting screw, reel	G364625	3.95
46	472519	Plug, adjusting handle	G472519	0.40
47	549633	Element, air filter	G549633	15.25
48	132532	Height adjusting assembly, R.H.	G132532	92.72
49	132533	Height adjusting assembly, L.H.	G132533	92.72
50	131814	Roller Mount assembly, L.H.	G131814	39.95
51	131815	Roller Mount assembly, R.H.	G131815	39.95
52	163467	Screw assembly, H.O.C. assembly	G163467	16.45
53	163920	Body assembly, R.H.	G163920	34.95
54	163921	Body assembly, L.H.	G163921	34.95
55	304392	Bushing, height of Cut Body Assembly	G304392	1.95
56	412003	Set screw, Sq. Hd. 1/2-13 x 1 1/4"	G412003	0.60
57	443818	Nut, 1/2-13 Jam	G443818	0.21
58	365994	Adjusting handle, reel	G365994	33.78
59	400260	Bolt, Hex Hd. 3/8-16 x 7/8	G400260	0.40
60	446142	Lockwasher	G446142	0.12
61	-	Grooved roller overhaul kit	G100137	39.95
62	-	Oil filled roller overhaul kit	G100140	59.45