

GANG MOWER UNITS
 MODEL 303,305,756,856,3325 & 3365

FOR ESP CUTTING UNIT REFER
 TO PREVIOUS PAGE

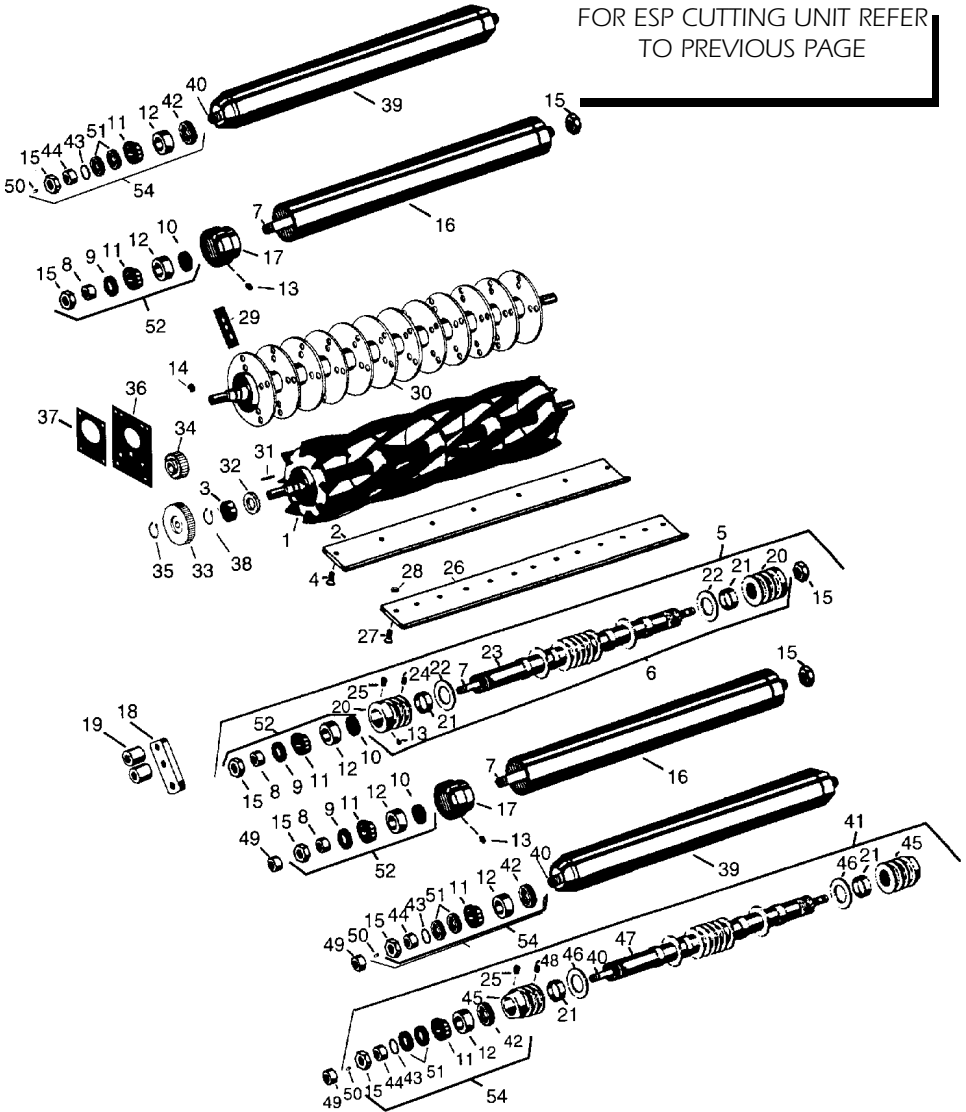

TEL: (0114) 251 3344
FAX: (0114) 251 3000

GANG MOWER UNITS

MODEL 303,305,756,856,3325 & 3365

Key No	OEM Part No	Description	Our Part No	Price £
Cylinders Available				
1	ET11306	4 Blade Cylinder 8"Ø	GET11306	110.95
1	ET11308	6 Blade Cylinder 8"Ø	GET11308	118.95
1	AET10900 ET13665 AET10425	6 Blade Cylinder	GAET10900	127.95
1	ET11310 AET10426 ET13666	8 Blade Cylinder 8"Ø	GAET10426	137.95
1	ET11439 AET10427 ET13667	10 Blade Cylinder 8"Ø	GAET10427	143.95
Bottom Blades Available				
2	ET11434	Bottom Blade 7 Hole	G00102	15.55
2	ET11540	Bottom Blade 7 Hole, Low Cut	G00104	16.55
Other Parts Available				
3	ET10824	Bearing, cylinder	GA203605	4.95
3	JD7678	Bearing, cylinder	GJD7678	7.95
4	ET11435	Screw, b/blade, 3/8-16 X 3/4	G170555	0.18
4	ET15804	Lock nut, b/blade 3/8-16	GET15804	0.25
5	-	2 3/4" Repairable grooved roller assembly	G500500R	156.95
6	-	Tube assy, Rep. Grooved Roller less shaft, bearings & seals	G500501R	109.95
7	-	Roller shaft	G500502	23.95
8	-	Wear sleeve, roller	G150674	6.65
9	-	Outer seal, roller	G253-117	3.34
10	-	Inner seal, roller	G253-122	2.38
11	-	Cone, bearing	G254-78	4.15
12	-	Cup, bearing	G254-79	2.85
13	-	Grease nipple	G302-5	0.52
14	RJD5801	Relief fitting	G302-14	2.35
15	N101345	Locknut	G3296-15	1.31
16	-	Solid roller assembly 2 7/8" dia	G500505	119.95
16	-	Tube only for Solid roller 2 7/8" dia	G500506	37.95
17	-	Roller end, 2 7/8" dia	G5-4035	30.45
18	ET13688	Roller bracket, front	GET13688	8.25
19	ET11414	Spacer, front roller bracket	GET11414	2.80
20	-	Threaded roller end, fits G500500R	G150670	41.95
21	-	13/16" Spacer, rep. grooved roller	G150671	0.62
21	-	1 1/4" HD Spacer, rep. grooved roller	G150676	1.40
22	-	2 3/4" Washer, rep. grooved roller	G150672	0.60
23	-	Threaded tube, fits G500500R	G150683	28.95
24	-	Nyloc set screw, 3/8"-16 X 3/8"	G150691	0.55
25	-	Pressure relief fitting	G170714	4.19
26	ET15739	Bottom Blade 13 Hole	G00107	17.95
26	ET15740 ET17591	Bottom Blade 13 Hole, Low Cut	G00108	18.95
27	19M5055	Metric screw, 13 Hole Bottom Blade only	G19M5055	0.42
27	ET15000	Screw, 3/8-16 X 1, 13 Hole Bottom Blade only	G190652	0.18
28	ET15804	Locknut, 3/8-16, 13 Hole Bottom Blade only	GET15804	0.30
28	14M7400	Nut, metric	G14M7400	0.50

Continues Next Page >>>>

GANG MOWER UNITS
MODEL 303,305,756,856,3325 & 3365

Key No	OEM Part No	Description	Our Part No	Price £
29	ET15712	V-Cut blade, long, inside discs	GET15712	1.49
29	ET15713	V-Cut blade, Short, Outside discs	GET15713	1.49
30	ET15302	Verticut shaft w/o blades	GET15302	249.95
31	ET11301	Key, cylinder shaft	GET11301	1.10
32	ET13673	Seal, cyl. motor end	GET13673	3.49
32	ET13674	Seal, cylinder	GET13674	3.79
33	ET11300	Gear, cylinder	GET11300	69.95
34	ET11299	Gear, hyd. motor	GET11299	34.95
35	R26192	Snap ring, cylinder	G1056	0.38
36	ET10872	Gasket, gear case	GET10872	1.40
37	ET10873	Gasket, hydraulic motor	GET10873	1.40
38	NI23155	Snap ring, cylinder	GN123155	1.05
39	AET10443	Solid roller assembly	GAET10443	126.95
40	ET15758	Shaft	GET15758	23.95
41	AET10350	3" Repairable grooved roller assembly	G500507	161.95
42	ET15756	Inner seal, fits JD rollers only	GET15756	2.65
42	-	Inner seal, fits Garfitts rollers	G253-122	2.38
43	U46731	O ring	G237-54	0.30
44	ET15726	Wear sleeve, hardened	GET15726	6.95
45	-	Threaded roller end, 3" dia	G500511	41.95
46	-	3" Washer, rep. Grooved roller	G150673	0.60
47	-	Threaded tube, fits G500507	G500510	28.95
48	-	Nyloc set screw, 3/8-16 X 3/8	G150691	0.55
49	MT74	Bushing, roller bracket	GMT74	1.10
50	JD7759	Grease fitting	G471219	1.30
51	ET15755	Outer seal	GET15755	2.45
52		Roller overhaul kit, fits G500500R & G500505	G100137	39.95
		contains: 2 X G302-5, 2 X G253-122, 2 X G150674, G254-78, G254-79, G3296-15		
53		Cutting Unit Overhaul Kit	G100173	26.95
		contains: 1 X GET13673, 1 X GET13674, 1 X GET11301, 1 X G1056, 1 X GET10872, 1 X GET10873, 1 X GN123155, 2 X GET10824		
54	AET10632	Roller Overhaul kit, fits GAET10443 & G500507 FITS MK II & ESP 3" Solid Grooved Rollers	GAET10632	38.95
		contains: 2 X GET15756, 2 X G253-122, 2 X G254-79, 2 X G254-78, 2 X G237-54, 2 X GET15726, 2 X G3296-15, 2 X G471231, 2 X G471219, 4 X GET15755		

TEL: (0114) 251 3344
FAX: (0114) 251 3000