

220 GREENSMOWER

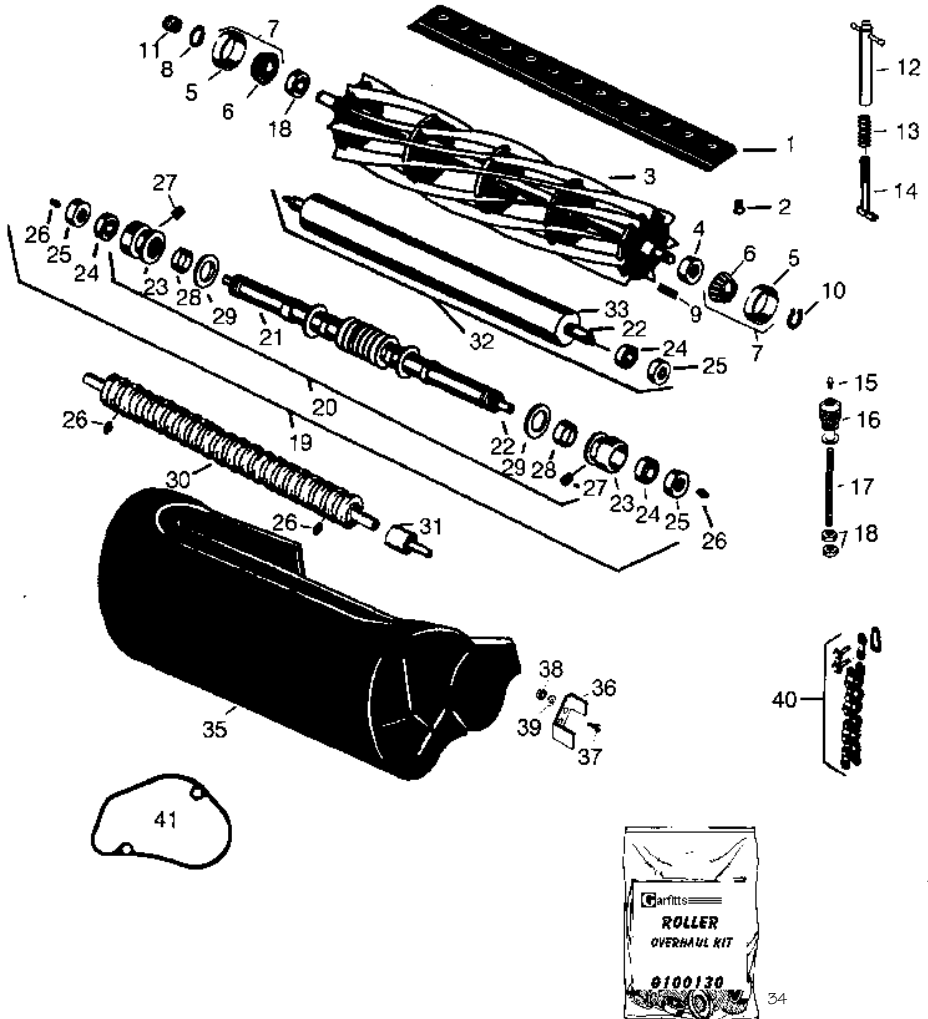

220 GREENSMOWER

| Key No | OEM Part No | Description | Our Part No | Price £ |
|----------------------|--------------------|---|-------------|---------|
| Bed Knives Available | | | | |
| 1 | ET11066 - ET17532 | Bed knife, thick 3/16" | GET17532 | 19.50 |
| 1 | ET17533 - ET14402 | Bed knife, thin 1/8" | GET14402 | 19.50 |
| 1 | ET17533 - ET14402 | Bed knife, thin 1/8" Tungsten Tip | GET14402TP | 53.30 |
| 1 | ET17534 - ET17489 | Bed knife, 3/32" Super thin | GET17489 | 19.95 |
| 1 | ET17534 - ET17489 | Bed knife, 3/32" Super thin Tungsten Tip | GET17489TP | 55.85 |
| 2 | 21M7194 - 101278 | Screw | G101278 | 0.21 |
| Cylinders Available | | | | |
| 3 | AMT537 | Cylinder, 11 blade | GAMT537 | 135.15 |
| 4 | MT1160 | Seal, cylinder | GMT1160 | 4.20 |
| 5 | MT2108 | Bearing cup, cylinder | GMT2108 | 2.70 |
| 6 | AMT1108 | Bearing cone, cylinder | GAMT1108 | 5.95 |
| 7 | - | Tapered bearing set, includes GAMT1108 & GMT2108 | G500610 | 7.95 |
| 8 | M44162 | O-ring, cylinder | GM44162 | 0.64 |
| 9 | 49M7049 | key, cylinder | G49M7049 | 1.65 |
| 10 | 40M7080 | Snap ring, cylinder | G40M7080 | 0.21 |
| 11 | ET11053 | Spring, cylinder | GET11053 | 2.35 |
| 12 | ET11068 | Adjustment handle, short R.H. | GET11068 | 14.20 |
| 12 | ET11069 | Adjustment handle, short L.H. (shown). | GET11069 | 14.95 |
| 13 | ET11070 | Spring, bed knife adjusting | GET11070 | 2.95 |
| 14 | ET11372 | Bolt, bed knife adjusting | GET11372 | 4.35 |
| 15 | JD7798 | Grease nipple | G471219 | 1.30 |
| 16 | MT1087 | Adjusting knob, roller | GMT1087 | 9.95 |
| 17 | MT1088 | Stud, roller adjusting | GMT1088 | 3.30 |
| 18 | 14M7151 | Jam nut 8mm x 1.25 | G14M7151 | 0.33 |
| 19 | AET10557 | 2" repairable grooved roller assembly | G68527R | 98.95 |
| 20 | - | Tube assy., repairable grooved roller | G129806R | 55.95 |
| 21 | - | Threaded tube, grooved roller | G150654 | 16.45 |
| 22 | ET16251 | Shaft, grooved roller | G102030 | 23.03 |
| 23 | - | 2" Threaded roller end | G150650 | 26.45 |
| 24 | ET15220 | Bearing, grooved roller | G303558 | 7.98 |
| 25 | ET15219 | Seal, grooved roller | G305115 | 3.05 |
| 26 | JD7797 | Grease nipple | G302-5 | 0.52 |
| 27 | - | Nyloc set screw, 1/2" - 20 x 1/4" | G150690 | 0.40 |
| 28 | - | Spacer, grooved roller | G150651 | 0.42 |
| 29 | - | Washer, grooved roller | G150653 | 0.50 |
| 30 | AET10954 | Machined steel grooved roller | GAET10954 | 109.95 |
| 30 | - | Machined aluminium grooved roller | G500611 | 109.95 |
| 31 | AA35741 - AET10129 | Bearing, roller | GAET10129 | 15.95 |
| 32 | AET10111 | Solid roller | GAET10111 | 71.55 |
| 33 | - | Tube assy. without bearings & seals | G129594 | 40.95 |
| 34 | - | Roller Overhaul Kit- contains 2x G302-5, 2 x G303558, 2 x G305115 | G100130 | 21.37 |
| 35 | ET10210 | Grass basket | GET10210 | 65.95 |
| 36 | ET11112 | Bracket, R.H. | GET11112 | 5.45 |
| 37 | ET11113 | Bracket, L.H. | GET11113 | 5.45 |
| 38 | E68605 | Locknut | GE68605 | 0.32 |
| 39 | 24M7139 | Flat washer | G24M7139 | 0.35 |
| 40 | AMT734 - AMT1418 | Chain | GAMT1418 | 6.95 |
| 40 | ET11115 - AMT1419 | Chain | GAMT1419 | 8.25 |
| 40 | ET11148 | Chain | GET11148 | 8.95 |
| 41 | ET11043 | Gasket, gearcase, brush & V-cut | GET11043 | 2.95 |

Parts are not original. OEM part numbers are for reference purposes only.