

REPLACES TORO GREENSMASTER
1000 PARTS

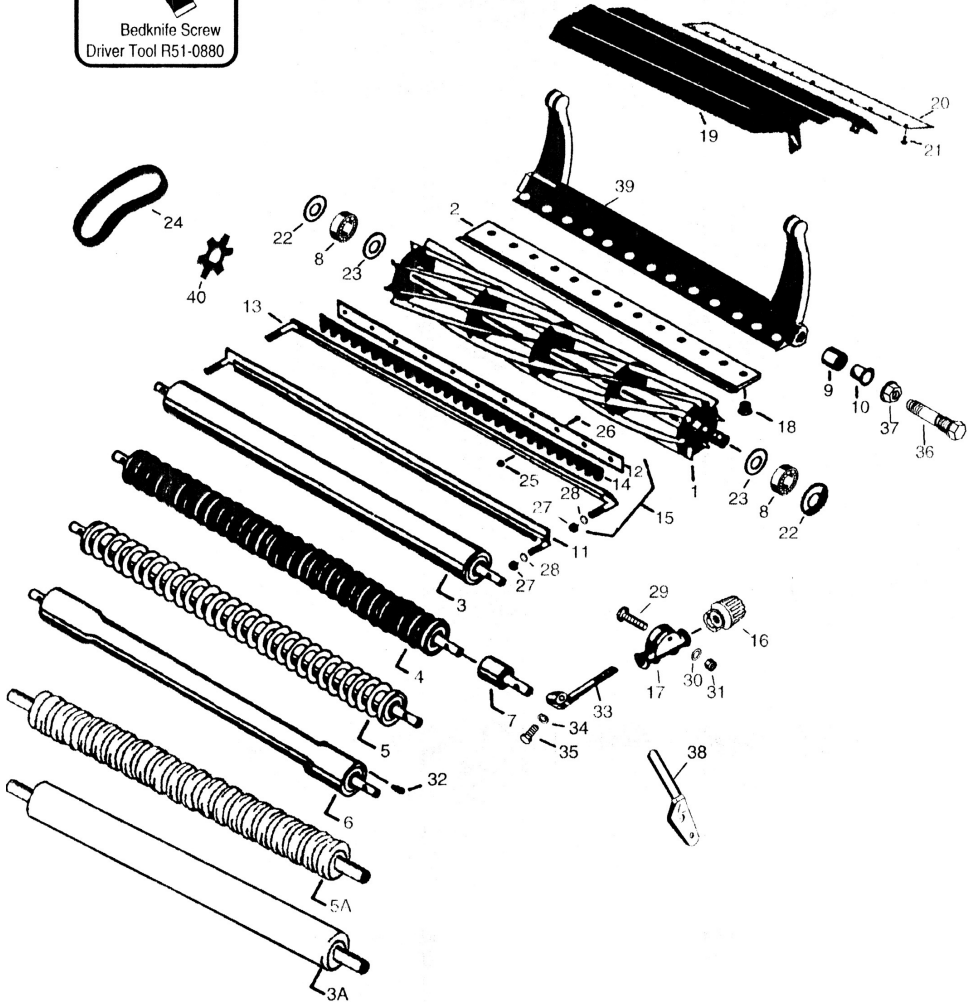

Continues Next Page >>>>>

**REPLACES TORO GREENSMaster
1000 PARTS**

Key No	O.E.M Part No	Description	Our PartNo	Price £
<i>Reels Available, Lifetime Guaranteed</i>				
1	13-8519	Reel, 11 Blade	G13-8519	176.95
1	92-9672	Reel, 8 Blade	G92-9672	154.02
<i>Bedknives Available, Lifetime Guaranteed</i>				
2	63-8470	Bed Knife, Thin 1/8"	G63-8470	18.25
2		GM1000 Hand GM300, 3000,3100, 3200, 3250 13 Hole Bed Knife 1/8" Tungsten Tip	G63-8470TP	53.30
2	62-2500	Bed Knife, Thick 3/16"	G62-2500	17.95
2	63-8560	Bed Knife, Super Thin 3/32"	G63-8560	18.95
2		GM1000 Hand GM300, 3000,3100, 3200, 3250 13 Hole Bed Knife 3/32" Tungsten Tip	G63-8560TP	55.85
2	65-8250	Bedknife, Tournament 1/16"	G65-8250	23.95
2	93-4263	Use R65-8250	G93-4263	-
<i>Rollers Available 88-6790</i>				
3	52-3170	Solid Roller 2" dia 4 lbs wgt1	G21-6440	77.65
3A	Only	UHMW Plastic Solid Front Roller 2" dia 7 lbs wgt	G150340	83.95
4	52-3200	Grooved Roller, Ductile Iron 2" dia 14 lbs wgt	G52-3200	119.95
4	88-6790	Aluminum Machined Grooved Roller 2" dia 5 lbs wgt	G88-6790	114.40
5A	Only	UHMW Plastic Grooved Front Roller 2" dia 8 lbs wgt	G150335	89.95
5	71-1550	Grooved Roller 2" dia 9 lbs wgt	G21-6540	111.89
6	52-3590	Swagged Roller, Machined Aluminum 2" dia 4 lbs wgt	G21-6470	84.95
<i>Other Parts Available</i>				
7	52-3180	Roller Bearing, Solid Roller	G52-3180	16.75
7	52-3210	Roller Bearing, Grooved Roller	G52-3210	15.95
8	251-342	Bearing, Reel	G251-342	14.95
9	63-9510	Bushing, Bed Bar	G63-9510	2.80
10	52-2890	Flanged Bushing, Bed Bar	G52-2890	0.78
11	33-1000	Brush Assy.	G33-1000	24.45
12	8-2520	Support, Comb	G8-2520	4.90
13	Only	Frame, Comb Assy.	G11-0069	14.95
14	8-2530	Comb	G8-2530	9.40
15	11-0070	Comb Assy.	G11-0070	33.55
16	10-5040	Use 65-8600	G10-5040	-
16	65-8600	Adj. Knob, Roller	G65-8600	12.81
17	10-5060	Height of Cut Adj.	G10-5060	12.95
18	57-4910	Plated Screw, Bed Knife	G150477	0.20
19	65-6410	Grass Shield, Incl. Item 20 & 21	G65 6410	32.95
20	-	Deflector	G150550	1.95
21	3295-46	Rivets	G3295-46	0.08
22	253-163	Seal, Reel	G253-163	3.89
23	253-96	Seal, Reel	G253-96	3.47
24	65-6200	Belt, Reel Drive	G150525	8.95
24	65-7270	Belt, Engine	G150526	6.95
24	65-6210	Belt, Drum Drive	G150527	11.05
25	3296-9	Locknut, Comb	G3296-9	0.24
26	3249-3	Screw, Comb	G3249-3	0.06
27	3219-1	Nut, 1/4-28	G3219-1	0.10
28	3254-8	Lockwasher, Internal Tooth	G3254-8	0.08
29	3230-5	Carriage Bol	G441674	0.44