

REELMASTER 5500, 6000,
6500D & 6700D PARTS

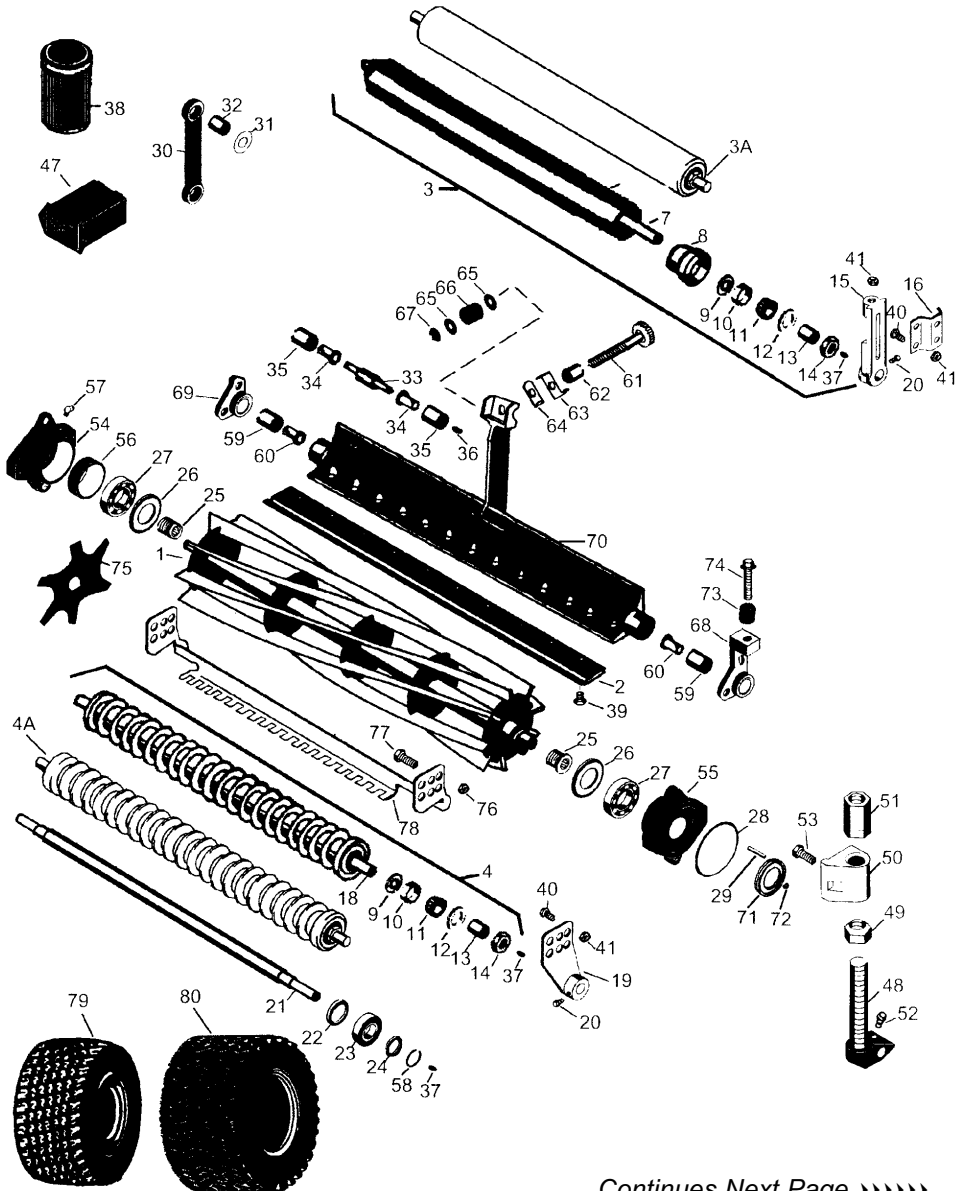

Continues Next Page >>>>>

**REELMASTER 5500, 6000,
6500D & 6700D PARTS**

Key No	O.E.M Part No	Description	Our Part No	Price £
Reels Available, Lifetime Guaranteed				
1	94-4337	Reel, 5 Blade	G94-4337	137.95
1	95-2770	Reel, 7 Blade	G95-2770	144.50
1	944338	Reel, 11 Blade	G94-4338	176.75
Bed Knives Available, Lifetime Guaranteed				
2	98-3994	Bed Knife, 2.200" (1/4") Height of Cut	G98-3994	23.50
2	93-9774	Bed Knife, 2.235" (3/8") Height of Cut	G93-9774	21.75
2	948936	Bed Knife, 2.535" (1/2") Height of Cut	G94-8936	25.75
Rollers Available				
3	-	Heavy Duty Solid Rear Roller 2-1/2" Dia 11 lbs weight	G150710	131.95
3	-	3" Solid Rear Roller Assy. w/Timken Bearings	G150725	137.95
3	99-5720	Use G150725	G99-5720	
3A	-	UHMW Plastic Solid Rear Roller 2-1/2 Dia 8 lbs weight	G150420	117.75
3A	-	3" UHMW Solid Rear Roller Assy, G500D	G150422	114.35
3	-	3" UHMW Rear Roller 26 3/4" Shaft	G150427	99.95
3	944331	Use G150710	G944331	
3	93-1250	Use G150710	G93-1250	
4	-	Heavy Duty Grooved Front Roller 3" Dia 21 lbs weight w/ Tapered Bearings	G150700	176.75
4A	-	UHMW Plastic Grooved Front Roller 3" Dia 8 lbs weight	G150415	135.15
4	93-2884	Use G150700	G93-2884	
4	944330	Use G150700	G944330	
Minuteman Rollers Available				
	MT6001	Minuteman Front Grooved Complete Roller Assy, with brackets	GMT6001	199.00
	MT6002	Minuteman Rear Grooved Complete Roller Assy, with brackets	GMT6002	199.00
	MT6003	Minuteman Rear Smooth Complete Roller Assy, with brackets	GMT6003	195.00
	M524	Minuteman Grooved Front & Rear Roller Only	GM524	167.00
	M525	Minuteman Smooth Rear Roller Only	GM525	159.00
	T621	Minuteman Front LH Bracket	GT621	29.25
	T622	Minuteman Front RH Bracket	GT622	29.25
	T231	Minuteman Rear LH & RH Bracket	GT231	35.00
	MMB157	Minuteman Bearing & Locking Collar	GMMB157	11.95
Overhaul Kits Available				
	-	Plastic Roller Overhaul Kit Fits All R&R UHMW Plastic Rollers. Includes Locknuts, Washers and Teflon Seals for added life. Incl: 2ea: G3296-15, G150347, G150333, G150334	G101395	14.95
Other Parts Available				
7	-	Shaft, Fits G150710 Only	G150713	24.95
7	93-1256	Shaft, Rear Roller, Fits OEM Roller Only	G93-1256	25.95
7	94-4328	Shaft, Rear Roller, Greaseable, Fits OEM Roller Only	G944328	29.95
8	-	End Cap, Heavy Duty Rear Roller	G61-0380	22.45
9	-	Inner Seal, Heavy Duty Rear Roller	G253-152	2.42
10	-	Cup, Timken, Heavy Duty Rear Roller	G254-79	2.85

Continues Next Page >>>>

**REELMASTER 5500, 6000,
6500D & 6700D PARTS**

Key No	O.E.M Part No	Description	Our Part No	Price £
11	-	Cone, Timken, Heavy Duty Rear Roller	G254-78	4.15
12	-	Outer Seal, Heavy Duty Rear Roller	G253-117	3.34
13	-	Wear Sleeve, Heavy Duty Rear Roller	G54038	6.65
14	-	Locknut, Heavy Duty Rear Roller	G3296-15	1.31
15	93-2904	Bracket, Rear Roller	G93-2904	14.25
16	61-0910	Bracket, Angle, Rear Roller	G61-0910	3.75
18	-	Shaft, Fits G150700 Only	G150702	26.95
19	944332	Front Roller Bracket, L.H. (Shown)	G94-4332	16.45
19	944333	FrontRollerBracket,R.H.	G94-4333	16.45
19	93-2985	Use G944332	G93-2985	
19	93-2898	Use G94-4333	G93-2898	
20	93-9757	Screw	G93-9757	1.25
21	944329	Shaft, Grooved Roller, Greaseable, Fits O.E.M. Only	G94-4329	26.95
21	93-2887	Shaft, Grooved Roler, Fits OEM Roller Only	G93-2887	25.95
22	93-3007	InnerSeal, Roller, Fits O.E.M. Only	G93-3007	2.25
23	109966	Ball Bearing, Roller, Fits O.E.M. Only	G343667	5.55
24	253-70	Outer Seal, Fits O.E.M. Only	G253-70	3.25
25	94-2732	Threaded Reel Insert, R.H.Thread	G94-2732	7.95
25	94-2733	Threaded Reel Insert, L.H. Thread	G94-2733	7.95
26	94-8908	Seal, Reel	G94-8908	3.65
26	93-2483	Use G94-8908	G93-2483	
27	93-2489	Bearing, Reel	G93-2489	15.75
28	93-9783	O-Ring, Reel	G93-9783	0.80
29	32121-69	Roll Pin	G32121-69	0.35
30	93-3087	Link Bar	G93-3087	10.45
31	94-2701	Washer, Hardened	G94-2701	1.05
32	94-8945	Bushing, LinkBar	G94-8945	1.95
33	57-5260	Pivot, Bed Bar	G57-5260	8.66
34	52-2890	Flanged Bushing	G52-2890	0.78
35	62-5510	Bushing	G62-5510	5.38
36	302-18	Grease Fitting	G302-18	0.80
37	302-5	Grease Zerk	G302-5	0.52
38	93-9162	Element, Air Filter	G93-9162	18.95
39	574910	Screw, Bed Knife	G150476	0.20
40	33105-025	Bolt, Hex Washer Hd.	G33105-025	0.65
41	33025-00	Jam Locknut, 10mm x 1.5	G33025-00	0.35
42	95-2783	Support Rod Assy	G95-2783	19.95
43	95-2790	Nut, RollerAdj., Long	G95-2790	3.75
44	95-7733	Bracket, H.O.C.	G95-7733	15.95
45	95-2789	Nut, Roller Adj. Shaft	G95-2789	1.95
46	57-6380	Bolt, Hex Hd.	G57-6380	0.39
47	75-6820	Hour Meter	G75-6820	32.85
48	95-2783	Support RodAssy, HOC	G95-2783	19.95
48	100-2263	Roller Bracket, HOC	G100-2263	46.75
49	95-2789	Lower Cone Nut,RollerAdj.	G95-2789	1.95
50	95-7733	Front RollerBracket, HOC	G95-7733	15.95
50	100-Z61-01	Bracket, HOC, Front	G100-2261-01	14.95
50	100-Z62-01	Bracket, HOC, Rear	G100-2262-01	14.95
51	95-2790	UpperCone Nut,RollerAdj.	G95-2790	3.75

Continues Next Page >>>>>

**REELMASTER 5500, 6000,
6500D & 6700D PARTS**

Key No	O.E.M Part No	Description	Our Part No	Price £
52	57-6380	Bolt, Hex Hd, 8mm x 25mm	G57-6380	0.39
53	33115-016	Bolt, Hex Hd, 10mm x 16mm	G33115-016	0.59
54	93-9794	Housing, Reel Brg. RH	G93-9794	49.95
55	93-9795	Housing, Reel Brg. LH	G93-9795	49.95
56	93-2922	Wear Sleeve	G93-2922	4.25
56	93-9793	Use G93-2922	G93-9793	
57	302-11	Grease Zerk, 1/428 45 Deg.	G700414	1.05
58	32120-62	Retaining Ring, Fits O.E.M. Roller Only	G32120-62	1.15
59	93-7501	Bushing, Bed Bar	G93-7501	2.25
60	93-7502	Nylon Flanged Bushing, Bed Bar	G93-7502	0.89
61	95-2762	Adj. Handle, Bed Bar 6500D & 6700D	G95-2762	19.95
61	93-2957	Use G95-2762	G93-2957	
61	95-8877	Adj. Handle, Bed Bar 5500 & 6000	G95-8877	17.95
62	93-2959	Spacer, Bed Bar Adjuster	G93-2959	1.25
63	95-8752	Spring Arm, Bed Bar Adjuster	G95-8752	5.25
64	93-2892	Pivot, Bed Bar Adjuster	G93-2892	1.75
65	29-8910	Washer	G453017	0.36
66	95-0772	Spring, Bed Bar Adjuster	G95-0772	1.95
66	93-2915	Use G95-0772	G93-2915	
67	3296-62	Nut, 1/2-20 L.H.	G3296-62	0.76
68	93-2512	Pivot Hub, L.H. Bed Bar	G93-2512	18.75
68	100-3381	Pivot Hub, L.H. Bed Bar, Incl G93-7501	G100-3381	20.75
69	93-2513	Pivot Hub, R.H. Bed Bar	G93-2513	16.95
69	100-3380	Pivot Hub, R.H. Bed Bar, Incl G93-7501	G100-3380	18.95
70	99-8698	Bed Bar	G99-8698	104.95
70	93-2957	Use G99-8698	G93-2957	
70	95-3458	Use G99-8698	G95-3458	
71	93-9786	Nut, Bearing Adjusting, Incl 1ea G3245-42	G93-9786	8.95
71	95-2793	Use G93-9786	G95-2793	
72	3245-42	Set Screw, 8-32 x 1/4"	G3245-42	0.60
73	93-2516	Spring, Pivot Hub, Bed Bar	G93-2516	2.45
74	93-2571	Bolt, Hex Hd.	G93-2571	1.45
75	93-3038-03	Vertical Mower Blade, 1/16" x 7 1/4"	G93-303-03	7.95
76	32128-20	Nut, Hex Serrated Washer Hd, 5/16-18	G445722	0.36
77	33105-030	Bolt, Hex Washer Head, 10mm	G33105-030	1.35
78	93-2967	Scraper Kit, Front Grooved Roller	G93-2967	134.95
78	93-3074	Scraper, Front Grooved Roller	G93-3074	27.95
79	86-5910	Tire, 20-10x104 Ply Turf Trac, Fits 5500&6000	G700167	61.75
80	98-2373	Tire, 26.5-14x124 Ply Ultra Trac, Fits 5500&6000	G700198	136.95
80	94-8143	Tire, 29-14x15 B Ply Ultra Trac, Fits 6500D & 6700D	G94-8143	197.95

TEL: (0114) 251 3344 FAX: (0114) 251 3000